

STEM CASE STUDY

 **CPL** | SPECIALIZES
IN SOLUTIONS



EXISTING



PROPOSED

**CPL is ready to assist
your K-12 school
district with
re-opening efforts.**

At CPL, we understand that school districts are eagerly looking at creative solutions to maximize health and safety in their buildings. Our architects, engineers and designers are actively reviewing existing spaces and are ready to provide immediate solutions. Our Educational team understands the impact of the COVID-19 pandemic on our schools, facility, staff and students, and is hard at work re-imagining immediate solutions. We are also exploring the future design of classrooms and instructional spaces in regard to public health needs and engagement learning.

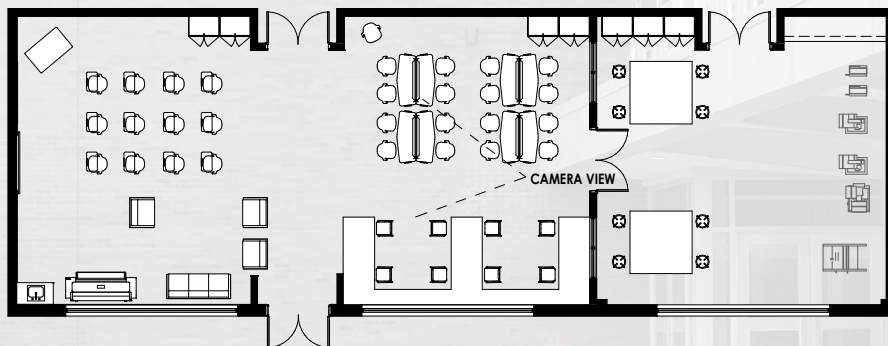

EXISTING STEM CLASSROOM

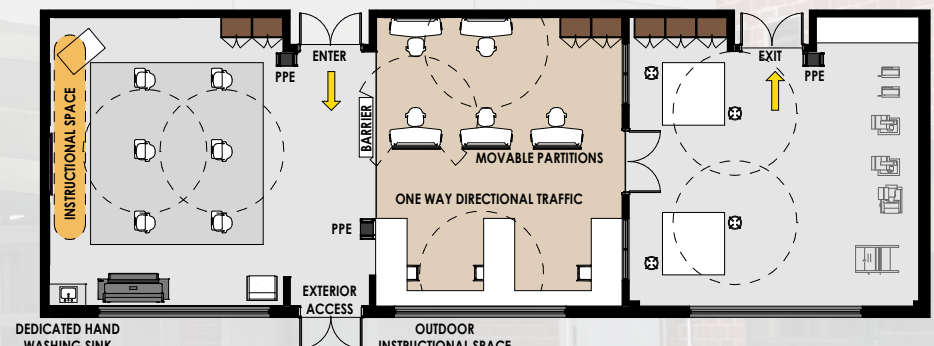

PROPOSED STEM CLASSROOM

EXTERIOR ACCESS
Encourage the use of the exterior spaces where

BARRIER
Adding lavender plant barriers in appropriate places encourages the flow of traffic and establishes distances between activities/zones. Lavender has been known to decrease stress and promote a calm environment. It also helps

Where teachers are wearing masks, provide additional acoustics and review PA technology requirements in each area to allow for clear verbal communication.

Provide movable whiteboard/glass partition for barrier separation between activities to be used as dual purpose.