



HEALTHCARE



K-12



HIGHER ED

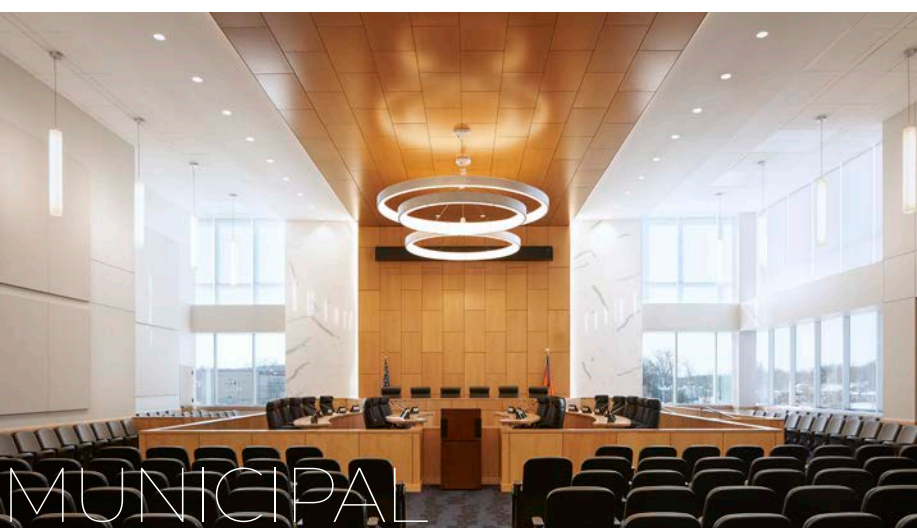

MUNICIPAL

---

# HEALTHY BUILDINGS

---

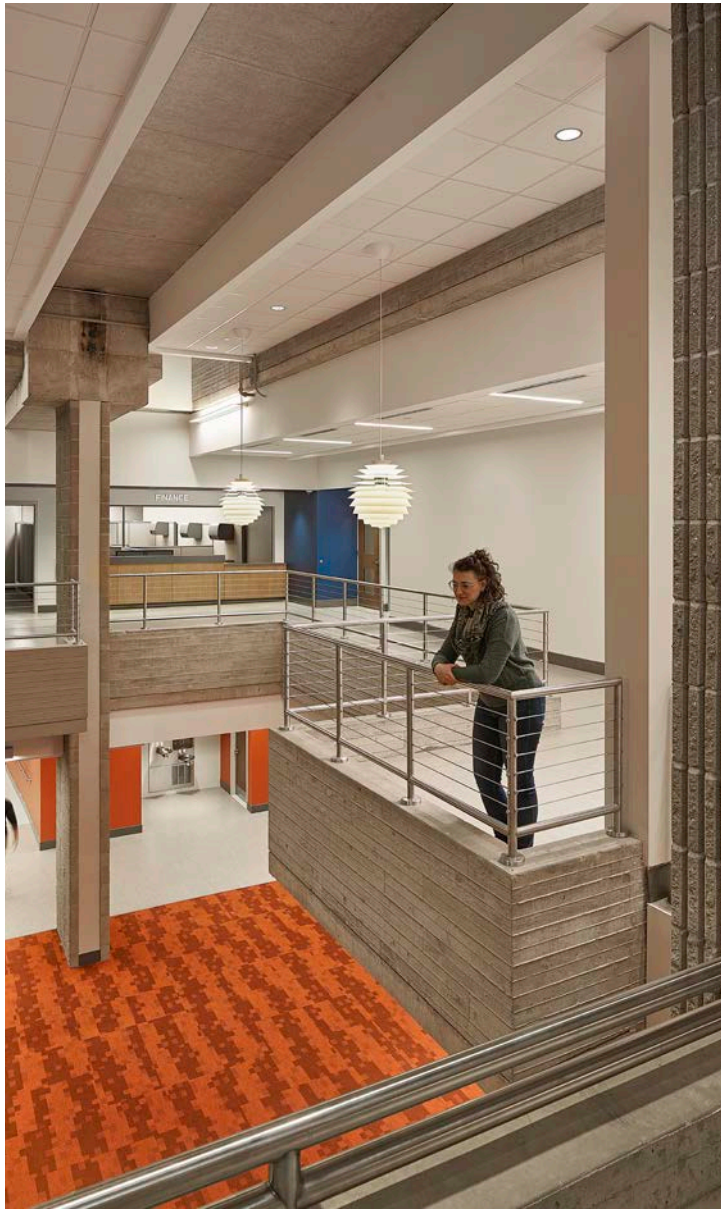

**CPL and Paradigm will help you develop a long term strategy to manage the impact of COVID-19 on your facilities.**

CPL is committed to working with our community partners during and after this unprecedented health crisis. We understand that your primary concern is for the health and safety of your staff and the people you serve. We share this common goal and we are ready to assist you with facility assessments, building systems reviews, and interior space planning services.

We are also prepared to connect you to our partners at Paradigm Environmental to help you evaluate your cleaning and disinfecting needs in this new era of COVID-19. Paradigm Environmental Services' team of Epidemiologists, Public Health Professionals, and Certified Industrial Hygienists (CIH) can assist you with your Emerging Pathogen Response Plan, cleaning and disinfecting program and verification needs.

Time is of the essence when responding to the range of possible impacts of COVID-19. We will seamlessly assemble the right response team to help you address the interim and post pandemic workplace considerations that are specific to your community. This is not a quick fix, 'band aid' approach, but a thoughtful process to help you address both pressing and future needs.

The response team assigned to your community can be made up of civil, mechanical, electrical and plumbing engineers, that can effectively evaluate your building systems. You may also wish to include interior designers and architects that can evaluate your space needs, identify potential hot spots and offer recommendations for alternative workspace configurations. Our friends at Paradigm can assist with critical cleaning and disinfecting needs. Together, we will help you develop a plan that is unique to your situation.

**We are committed to working with you through and after this crisis.**

---

Let CPL and Paradigm create a custom team to address your interim and post COVID-19 workplace needs.  
**We're in this together.**





# CPL > Full-Service Innovation



HIGHER ED



HEALTHCARE



K-12



MUNICIPAL

We propose a holistic approach to facility evaluation and emerging pathogen response planning. Recommendations will likely include a combination of strategies that are best suited for your people and your buildings.



## **FACILITY ASSESSMENT & DESIGN SERVICES**

- > Facility Systems Assessment
- > Building Modifications and Temporary Solutions
- > Interior Space Modifications:
  - Entry and Reception Areas
  - Circulation Patterns
  - Workstation Layouts and Dividers
  - Density Solutions
- > Specifications of Products to Enhance Employee Safety



## **BUILDING SYSTEMS**

- > System Audits
- > Ultra-violet Germicidal Irradiation
- > Enhanced Filtration
- > Antibacterial Lighting
- > Web-based, Event-based Controls
- > Stand-by Power
- > Increased Ventilation
- > Air Distribution
- > Sensor Operated Faucets, Flush Valves



## **PATHOGEN RESPONSE PLAN**

- > Cleaning and Verification Testing
- > UV Disinfecting Solutions
- > Cleaning and Disinfecting Project Monitoring and Management
- > Cleaning and Disinfecting Workplan Development Training

[CLICK HERE TO LEARN MORE ABOUT CPL'S COVID-19 RESPONSE SERVICES](#)



**Dave Hart, P.E.** Vice President  
585.402.7520 [dhart@cplteam.com](mailto:dhart@cplteam.com)



**Brad Arthur** Vice President  
315.771.3738 [barthur@paradigmenvllc.com](mailto:barthur@paradigmenvllc.com)